

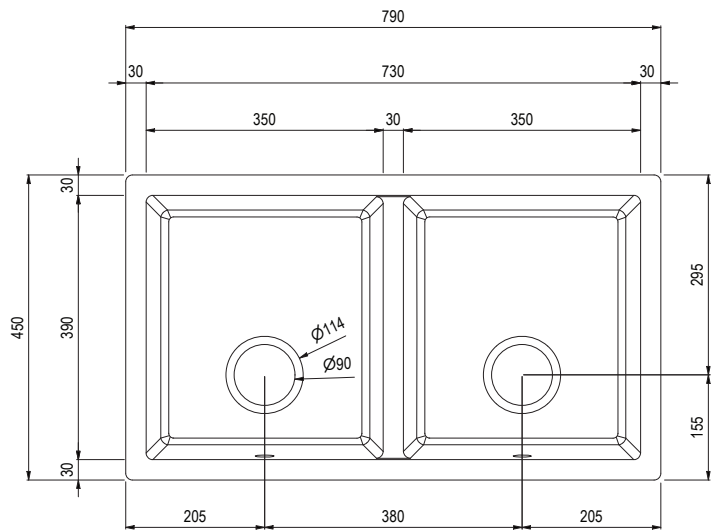

# VERA DOUBLE SINK

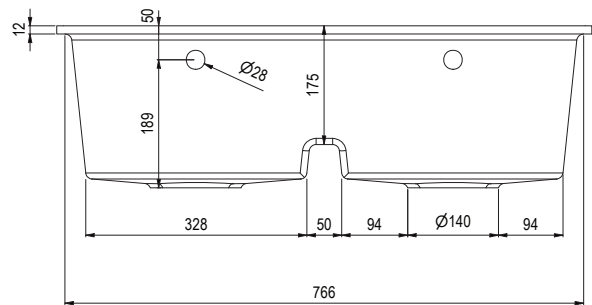

Top View



Back View

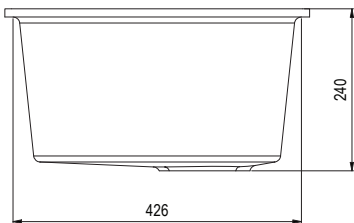

Side View

**Note:** Dimensions are nominal measurements only

SPECIFICATIONS	
RECOMMENDED USE	Domestic, Commercial
MATERIAL	Composite Black Granite
CONSTRUCTION	80% Granite Quartz/ 20% Acrylic Resin
INSTALLATION	Undermount, Top Mount
OVERFLOW	Yes
WARRANTY	Structure: 25 years
LITRE	48 Litres

Disclaimer: Products in this specification manual must by regulation be installed by licensed and registered trade people. The manufacturer/distributor reserves the right to vary specifications or delete models from their range without prior notification. Dimensions are nominal measurements only. Dimensions and set-outs listed are correct at time of publication however the manufacturer/distributor takes no responsibility for printing errors. All ABI Products are designed in Australia. Copyright ABI Interiors Pty Ltd 2021.



## CUT-OUT TEMPLATES

### TOPMOUNT INSTALLATION

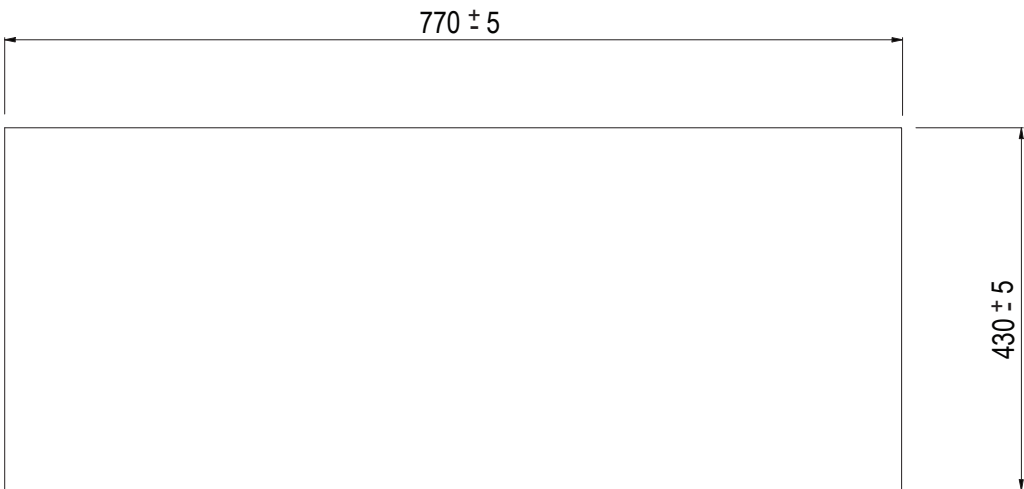

### UNDERMOUNT INSTALLATION

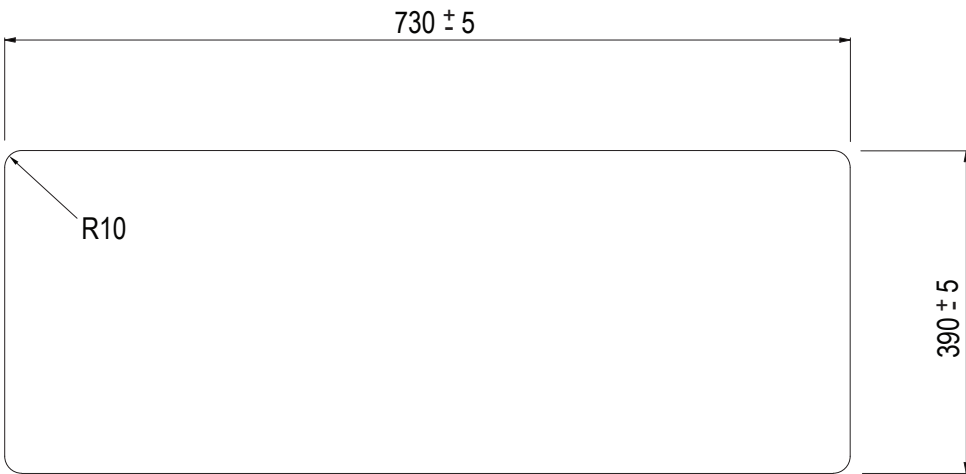

Whats in the Box	2x Screw		1x Sink	
	2x Cap			
	2x Bracket			
	2x Overflow			

**Note:** Product does not include basket waste

# INSTALLATION GUIDE - TOP MOUNT SINK

Note: This product must be installed by a licensed tradesperson.  
This is a general installation guide - there are many factors that are involved that can alter the installation method.

- 1

Mark out desired location of sink using the cut out template dimensions provided.

Cut out sink hole using preferred method.

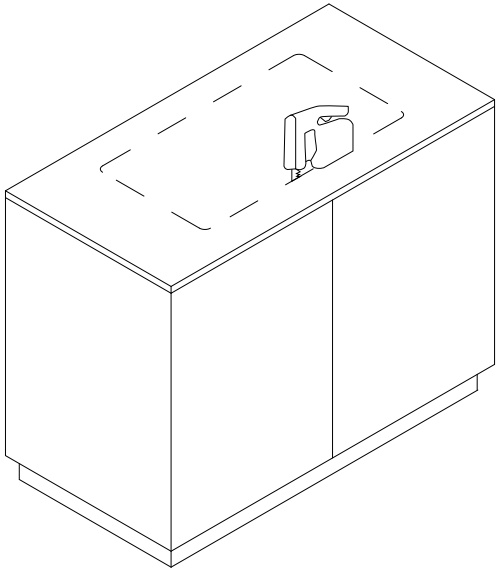

- 2

Clean around edge of benchtop sink hole & perimeter of sink rim.

Apply adhesive sealant to the underside perimeter of sink rim & lower into position.

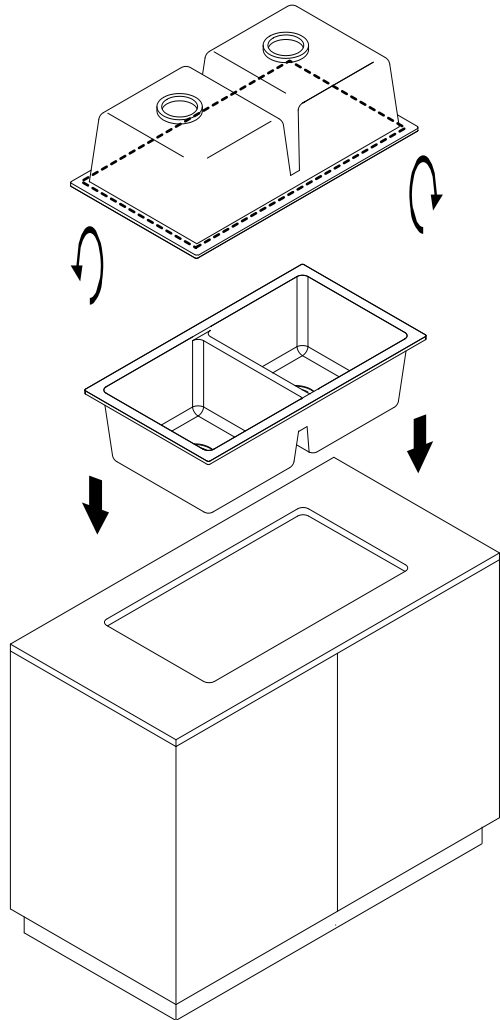

- 3

Wipe away any excess adhesive sealant around sink rim.

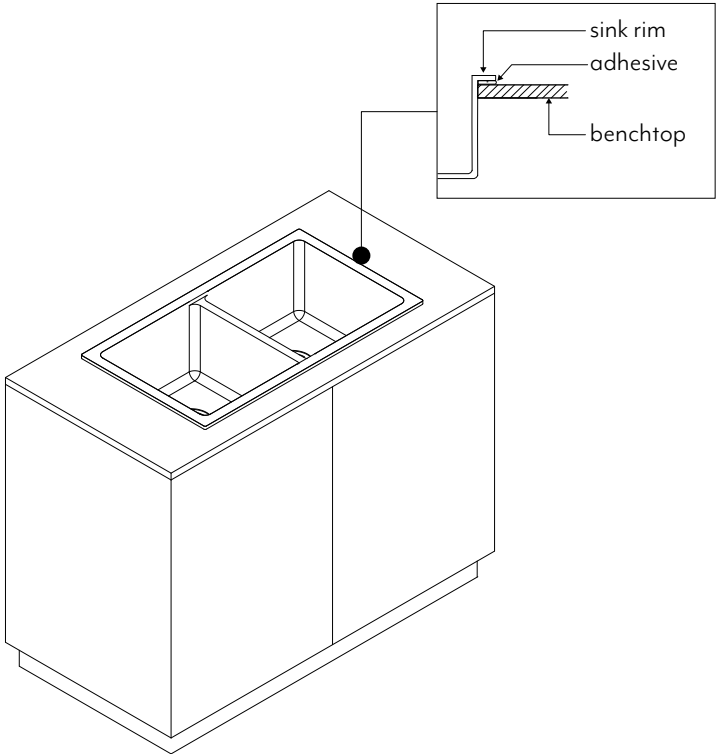

# INSTALLATION GUIDE - UNDERMOUNT SINK

Note: This product must be installed by a licensed tradesperson.  
This is a general installation guide - there are many factors that are involved that can alter the installation method.

- 1

Mark out desired location of sink using the cut out template dimensions provided.

Cut out sink hole using preferred method.

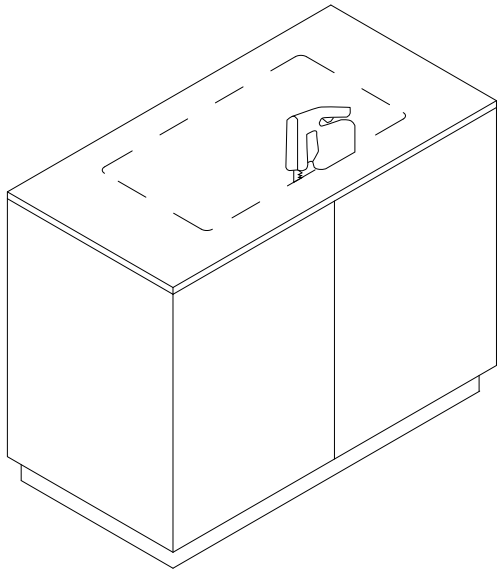

- 2

Clean around the edge of benchtop sink hole & perimeter of sink rim.

Position the sink in the cabinet below the benchtop hole. Apply adhesive sealant to the perimeter of sink rim & lift into position.

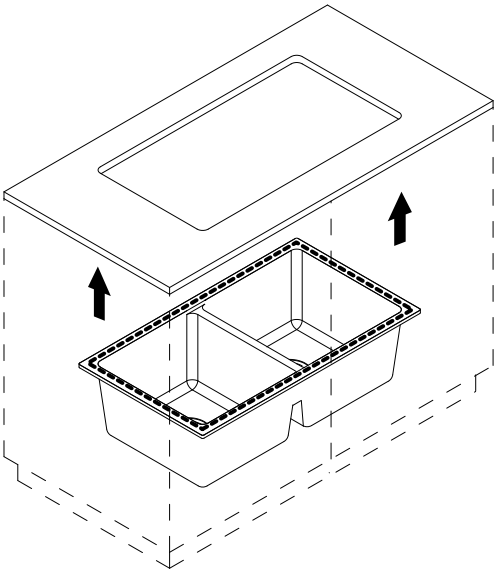

- 3

Lay a piece of timber across the benchtop hole & position in line with sink holes below.

Place clamps through the sink holes & tighten the clamps to hold the sink in place. Wipe away any excess adhesive sealant around benchtop opening.

Note: Use rags to protect surfaces when either the clamp or timber is making contact with the benchtop or sink.

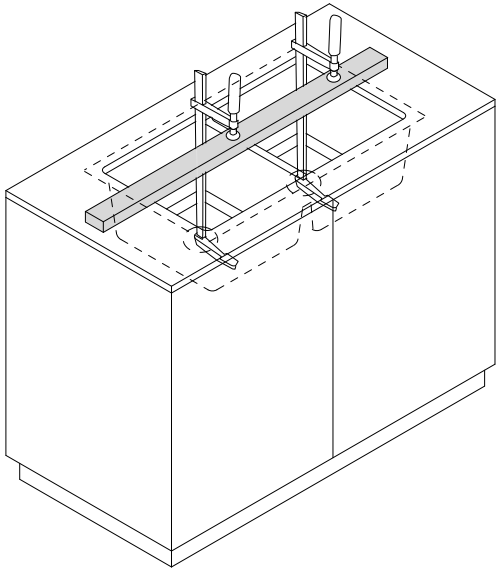

- 4

Using the benchtop material build rebated mounting tabs.

Clean around the underside perimeter of the sink & the mounting tabs.

Apply adhesive sealant to the mounting tab & fix it to the underside of the benchtop & sink rim. Repeat tabs at regular intervals. Wipe away any excess adhesive around mounting tabs.

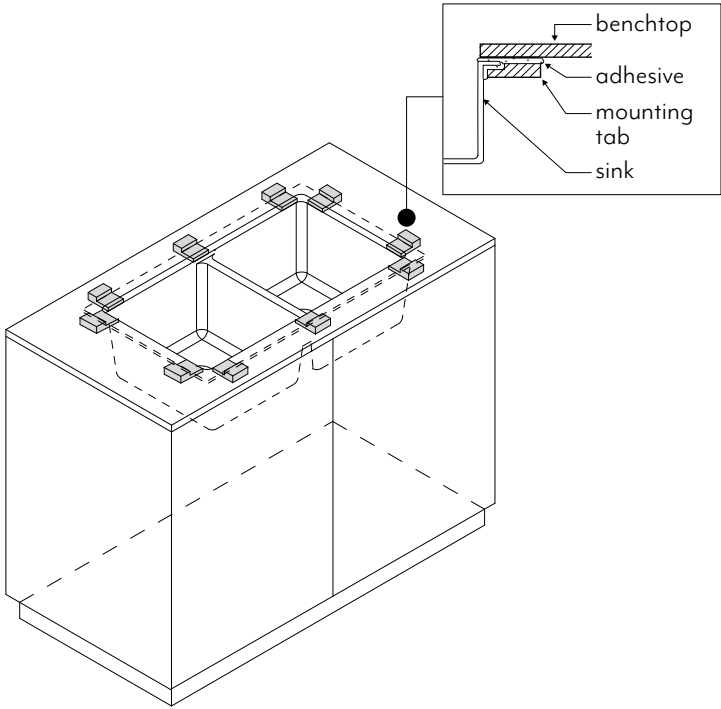

# INSTALLATION GUIDE

Note: This product must be installed by a licensed tradesperson.

This is a general installation guide - there are many factors that are involved that can alter the installation method.

1

Disassemble the basket waste and install into sink. Washer & SS Strainer bowl should be installed from the top. Rubber pad and body to be on the underside of the sink - tighten screw to fix parts together. Add Basket (Diagram 1)

2

Connect the flexible pipe to the body and screw on fitting to tighten.  
Push pipe onto the overflow fitting - pushing as far as possible

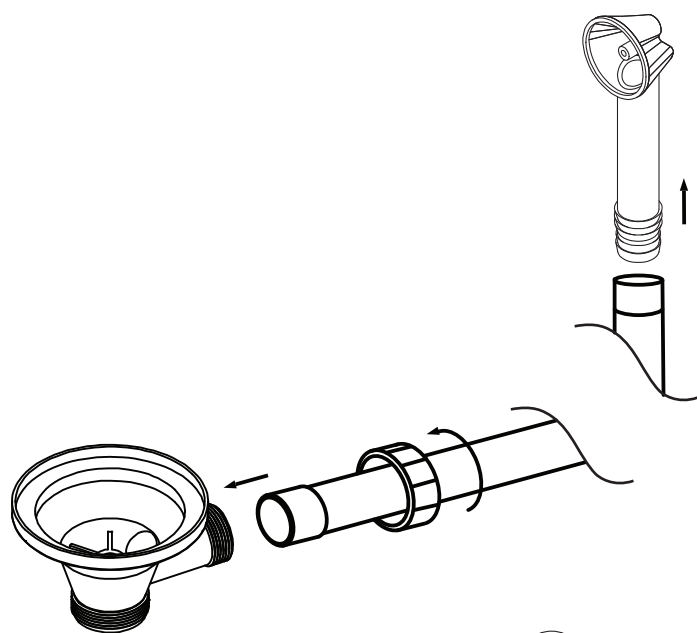
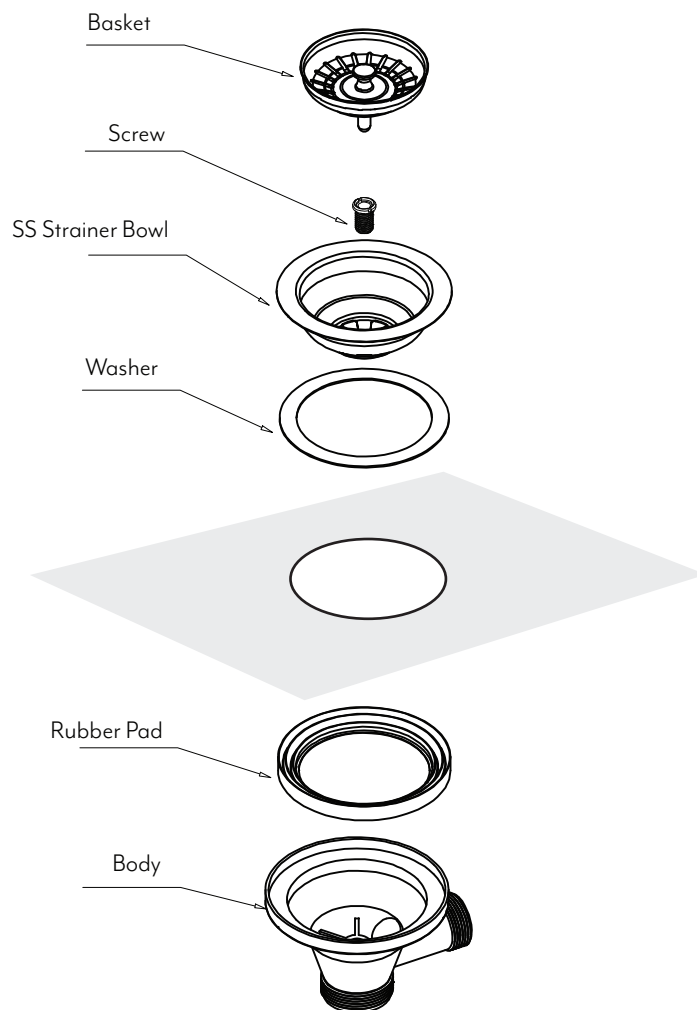

DIAGRAM 1



3

Add rubber seal into the overflow fitting, line up with hole and place on outside of sink. Tighten screw to fix parts together.

