

SPECIFICATIONS

RECOMMENDED USE	Domestic
COLOUR AVAILABILITY	<div> <div></div> <div></div> <div></div> <div></div> <div></div> <div></div> </div>
PRESSURE RATING	Recommended minimum working pressure 150kPa Recommended maximum working pressure 500kPa Hot and cold water inlet pressure should be equal
TEMPERATURE RATING	Maximum continuous working temperature 75°C If the water temperature exceeds 75°C, an approved tempering valve must be fitted
SUITABLE HOT WATER UNITS	Storage tank: Yes Continuous Flow: Yes Gravity Feed: Not suitable
STANDARDS	WELS Star Rating(5 Star) – Nominal Flow Rate(5.5 L/M) Registration No.(T32357)
WARRANTY	Structure: 25 years Finish: 5 years Cartridge: 10 years

Disclaimer: Products in this specification manual must by regulation be installed by licensed and registered trade people. The manufacturer/distributor reserves the right to vary specifications or delete models from their range without prior notification. Dimensions are nominal measurements only. Dimensions and set-outs listed are correct at time of publication however the manufacturer/distributor takes no responsibility for printing errors. All ABI Products are designed in Australia. Copyright ABI Interiors 2019. WWW.ABIINTERIORS.COM.AU

INSTALLATION MANUAL

TYPICAL INSTALLATION EXAMPLES

Please note that all instructions must be done by a licensed plumber, these examples are recommendations only

EXAMPLE ONE
Offset basin mixer/bath
spout setup

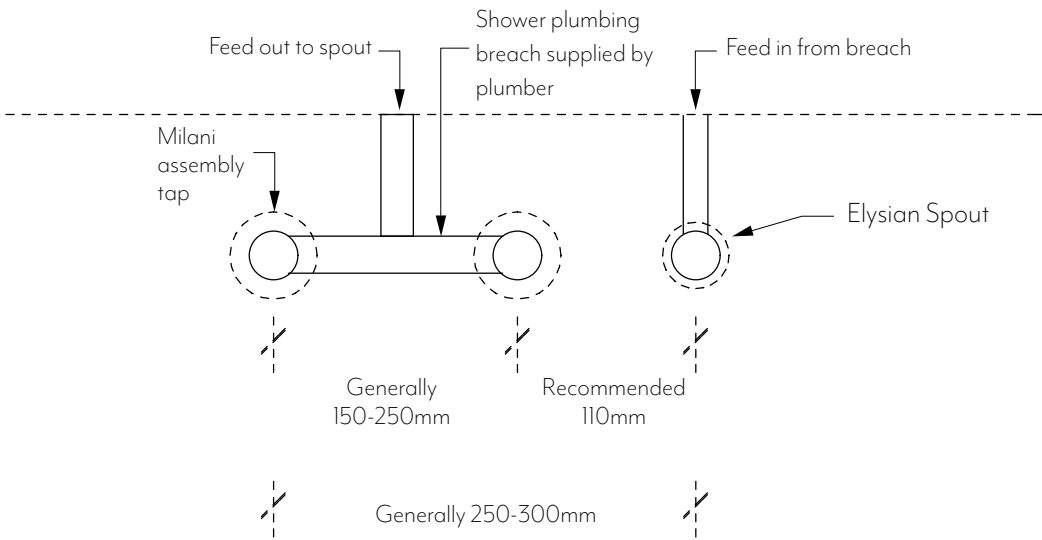

EXAMPLE TWO
Centered basin mixer/bath
spout setup

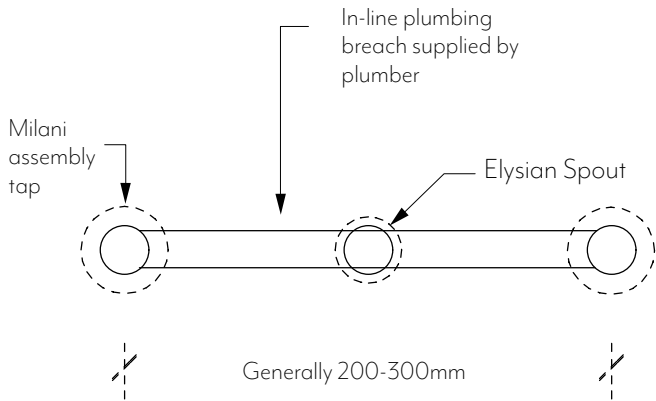

EXAMPLE THREE
Shower Setup

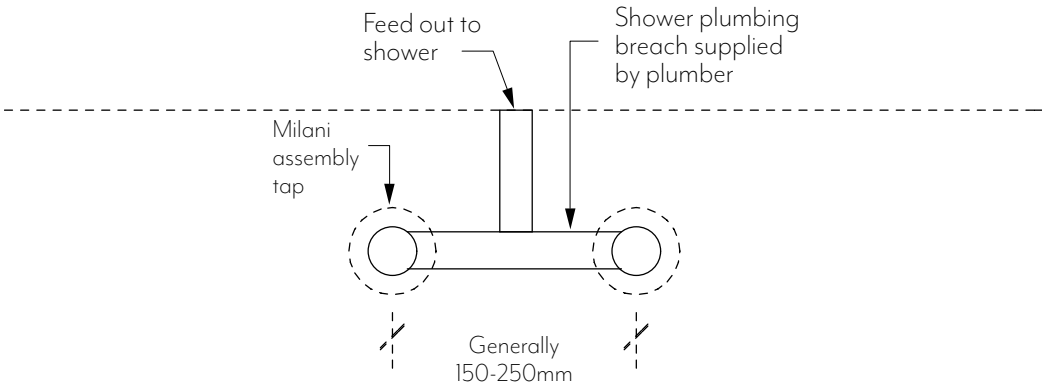

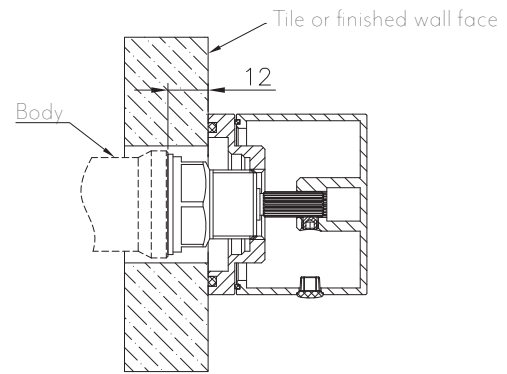
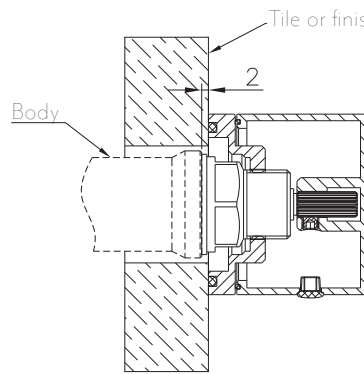
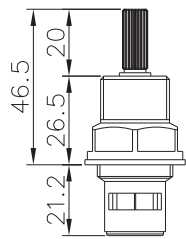

STANDARD

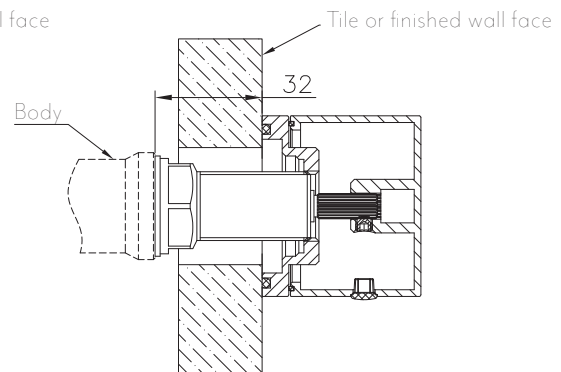
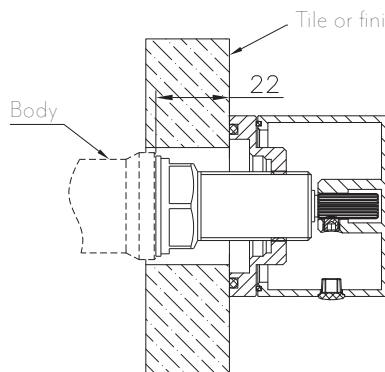
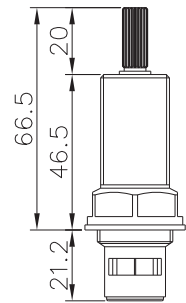

EXTENDED

****Extended spindles available upon request****

ABI

EXPLODED VIEW

Item Description Code

- 1-2 Spindle
- 3 O-Ring
- 4 Body
- 5 O-Ring
- 6 Handle
- 7 Grub Screw
- 8 Cap
- 9 Grub Screw
- 10 Allen Key

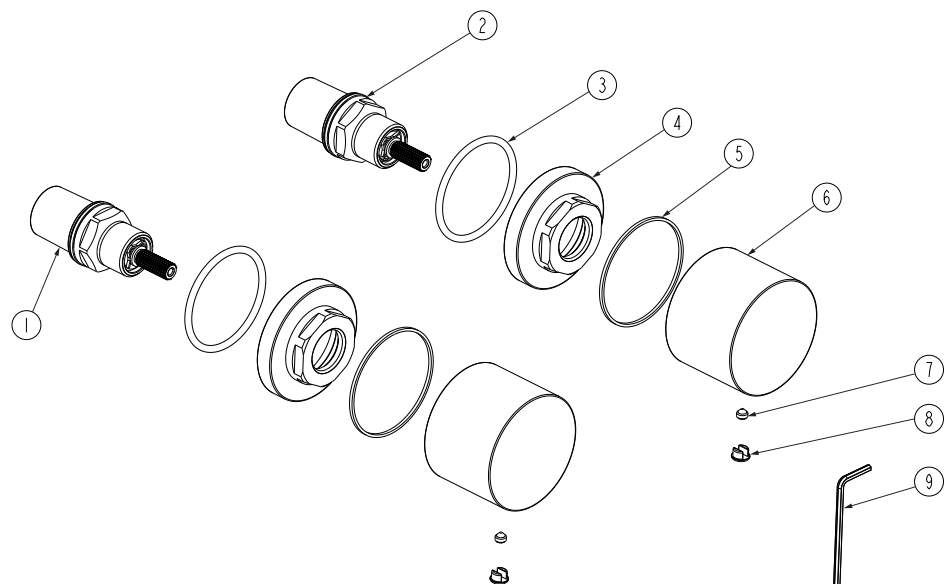

Regularly clean with mild liquid detergent or soap and water



DO NOT use cream cleaners or bleach. These substances are abrasive

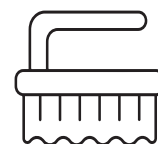

DO NOT use cleaning pads with abrasive surfaces as this may scratch the material