

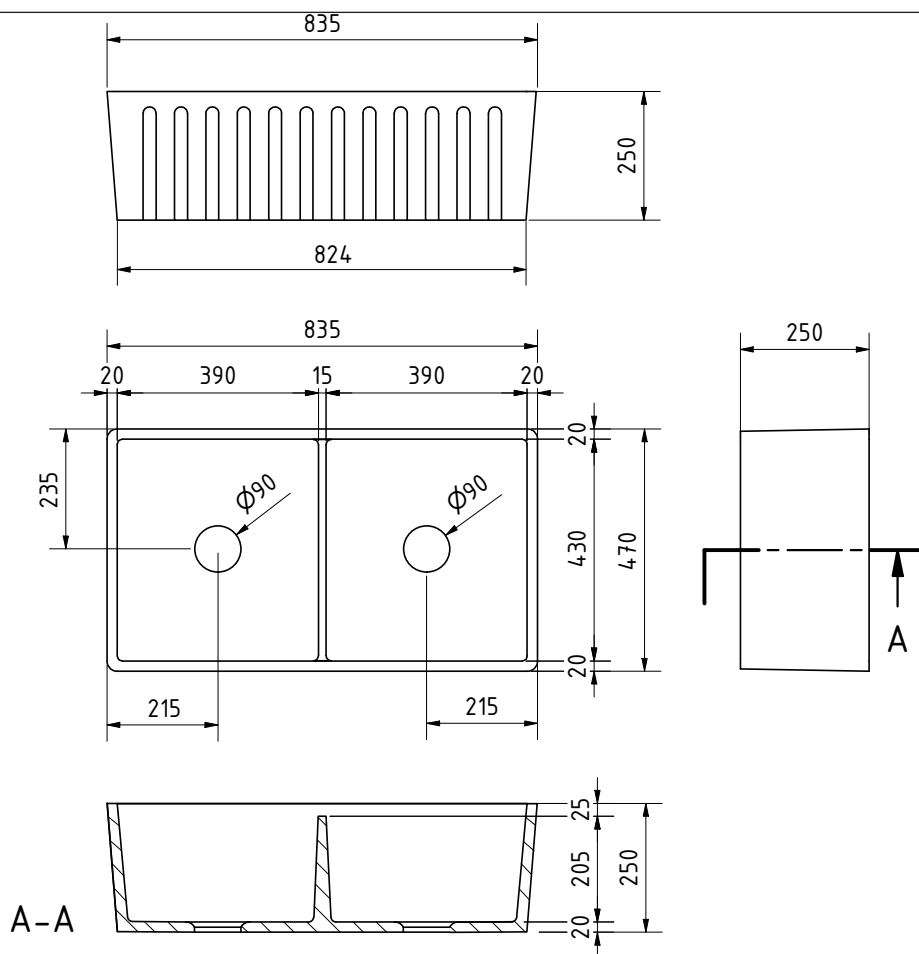

# HENLEY DBL FLUTED FARMHOUSE SINK



**NOTE: PRODUCT DOES NOT INCLUDE BASKET WASTE**

## SPECIFICATIONS

### RECOMMENDED USE

Domestic, Commercial

### COLOUR AVAILABILITY

White

### MATERIAL

Ceramic

### INSTALLATION

Undermount, Flushmount

### OVERFLOW

N/A

### WARRANTY

15 Years

### LITRE

58 Litres

### WEIGHT

43.8 kg

# INSTALLATION GUIDE - UNDERMOUNT SINK

Note: This product must be installed by a **licensed tradesperson**.  
This is a general installation guide - there are many factors that are involved that can alter the installation method.



- 1 Note: this basin can only be installed into new cabinetry & benchtops by a **licensed tradesperson**.

The sink must be available to tradespeople for taking measurements at time of manufacture. **ABI** is unable to provide templates due to variations in the material of the product.

Allow for the cabinetry to be designed so the sink front is sitting proud of cabinetry

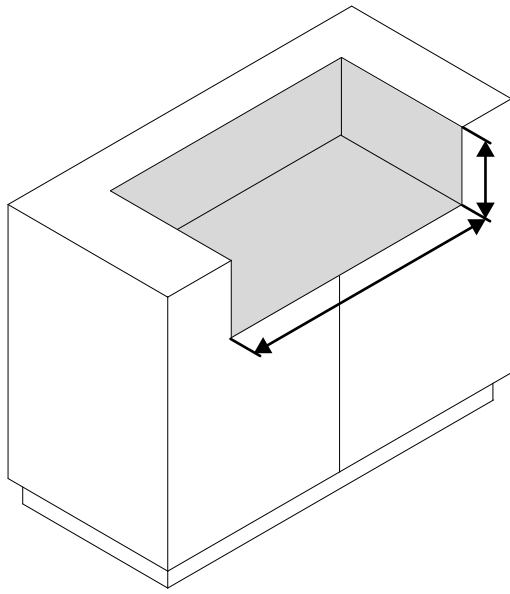

- 2 Mount the sink into the cabinet shelf ensuring the sink is level with the cabinet top.

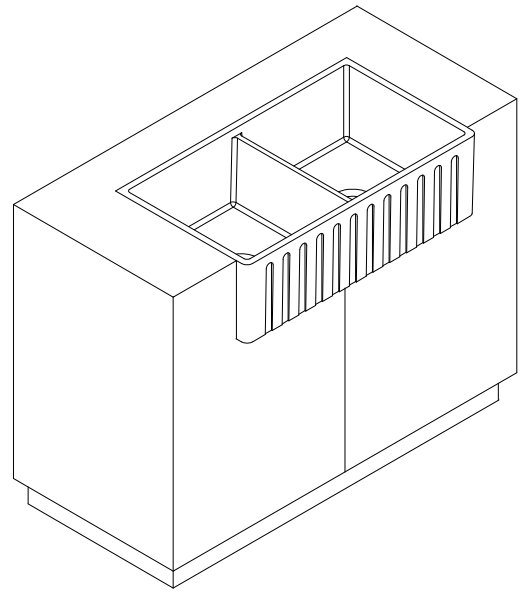

- 3 Cut the bench-top using the external measurements of the sink perimeter in conjunction with the desired sink overhang and cabinetry shelf.

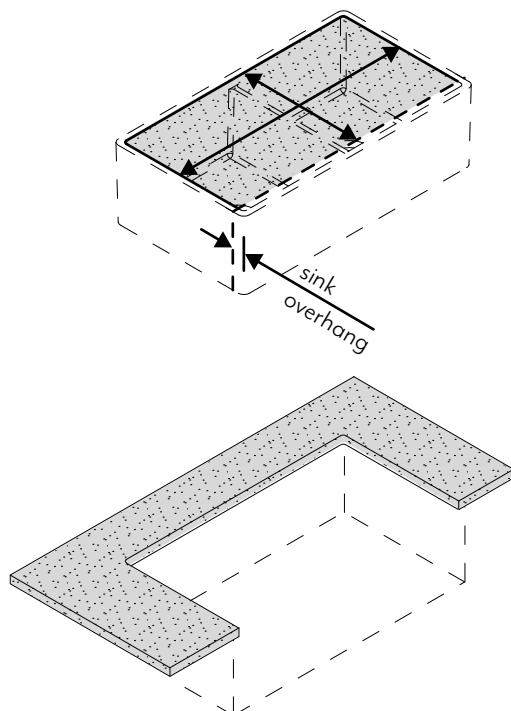

- 4 Install the benchtop & apply adhesive to sink perimeter. Wipe away any excess adhesive sealant.

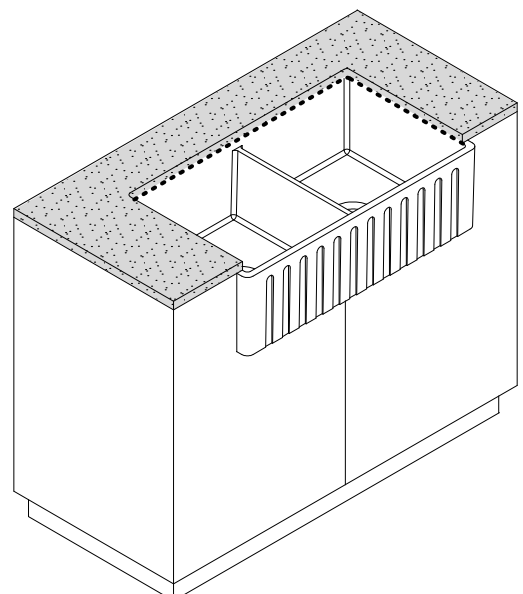

# INSTALLATION GUIDE - FLUSHMOUNT SINK

Note: This product must be installed by a licensed tradesperson.  
This is a general installation guide - there are many factors that are involved that can alter the installation method.



1

Note: this basin can only be installed into new cabinetry & benchtops by a licensed tradesperson.

The sink must be available to tradespeople for taking measurements at time of manufacture. **ABI** is unable to provide templates due to variations in the material of the product.

Allow for the cabinetry to be designed so the sink front is sitting proud of cabinetry & for additional depth of the benchtop to marry up with the level of the flushmount sink.

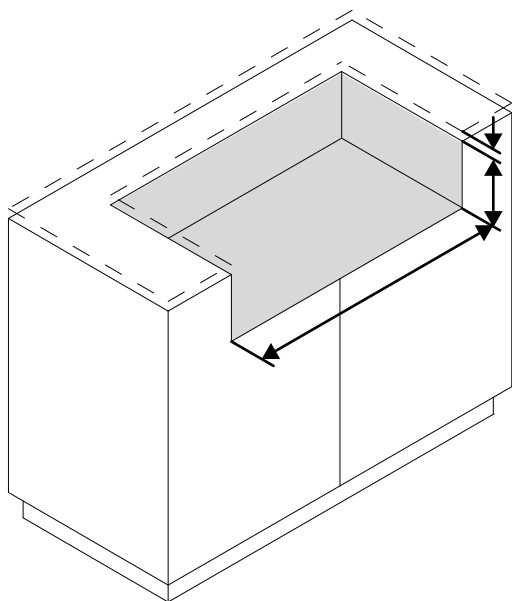

2

Mount the sink into the cabinet shelf.

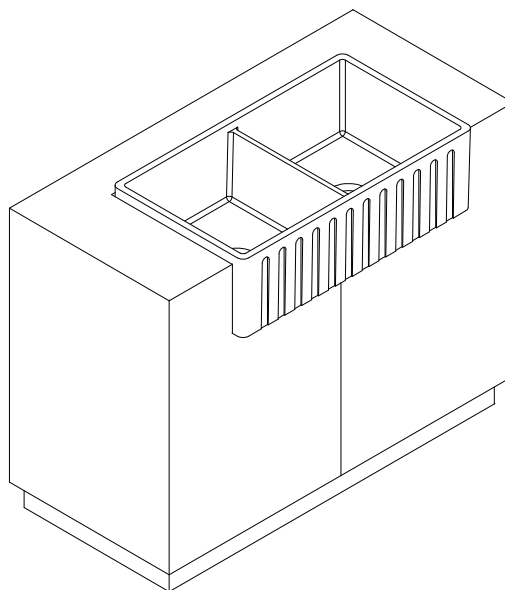

3

Cut the benchtop using the external measurements of the sink perimeter in conjunction with the desired sink overhang and cabinetry shelf.

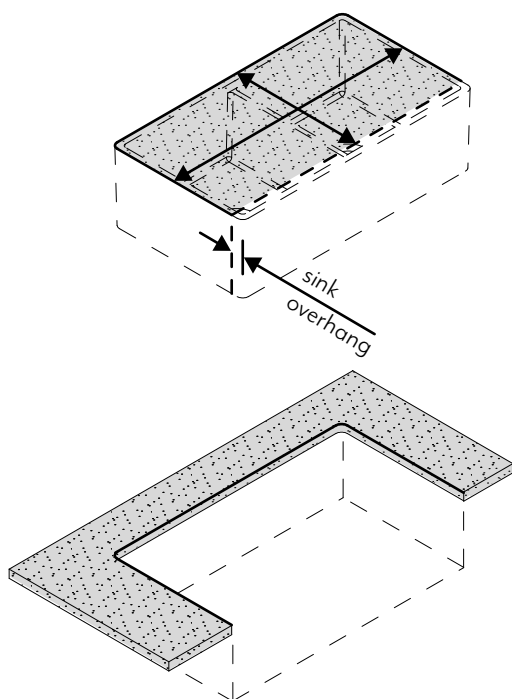

4

Install the benchtop & apply adhesive to sink perimeter. Wipe away any excess adhesive sealant.

